

November/December 2018

Volume LXXVIII Number 6

### Stay Connected

#### eBlast

sign up by emailing  
rpiablast@gmail.com

#### RPIA Website

www.rosedalepark.org



THE  
Rosedale Park

# NEWS

Rosedale Park • Detroit, MI 48223

www.rosedalepark.org

## Neighbors Tie for 2018 Best Home Landscaping!

The Island Beautification Committee has selected the following islands as winners in 2018:

1st place: Winner Circle award: Warwick between Fenkell and Chalfonte

2nd place: Rosemont between Fenkell and Chalfonte

3rd place: Glastonbury between Eaton and Lyndon

Most improved Winner Circle: Ashton between Chalfonte and Eaton

Best maintained Winner Circle: Artesian between Chalfonte and Eaton

Honorable Mention: Greenview between Chalfonte and Eaton

Honorable Mention: Artesian between Keeler and Fenkell

Best House Landscaping: a tie 15060 Artesian and 15063 Artesian

Prizes will be awarded at the March Gala. The block captain or those individuals who work on the islands must be present to accept the award. Contact one of the committee members with any questions: Carolyn Murphy 313-838-1769, Ruth Remus 313-587-5697, or Deborah Tunstill 313-549-1339.



15063 Artesian, home of Christopher and Lori Ann Stinson, Co-Winner of Best House Landscaping.



15060 Artesian, home of Tirria and Michelle Kendred, Co-Winner of Best House Landscaping.



## 2019 RPIA Nominee Bios



**PAM WEINSTEIN** | RPIA Presidential Candidate (2019)

I have lived in Detroit for 38 years, 34 of them in Rosedale Park. I have served as president of RPIA for the past three years, and I'm eager to take on the challenges of a fourth year in leadership. We continue to welcome new homeowners to Rosedale Park, and our home values are steadily increasing. With your support, our neighborhood continues to be a welcoming, friendly, and positive community.

Let's make 2019 another great year in Rosedale Park!



**STACY PUGH** | 1st Vice President Candidate (2019)

I am 13 year resident of Rosedale Park, a former President of RPIA, and has served on RPIA's Executive Board for the past 9 years. I'm also active on the code enforcement committee. I am a dedicated member of the community, committed to working to keep Rosedale Park a great place to live.



**STEPHANIE A. YOUNG** | 2nd Vice President Candidate (2019)

Stephanie A. Young is a lifelong Detroit, a graduate of Cass Tech HS and Michigan State University. She and her two sons Darius and David became residents of the historic Rosedale Park neighborhood in November 2009.

She is running for a board position because she cares about her community and looks forward to utilizing her experience and connections as a previous Mayor's Office District Manager and Neighborhood City Hall Manager.



**FRANK RABEN** | RPIA Treasurer Candidate (2019)

I have been serving RPIA as Treasurer for the past five years and have lived in Rosedale Park since 1978. I have also served as Rosedale Park's representative on GRDC's board for 29 years and as a Block Captain for ten years.

I am retired and being treasurer gives me something to do, and is an honor to be trusted by the Membership and RPIA Board, to look after RPIA's finances.



**PHIL SCHLOOP** | Board Member Candidate (2019-2021)

Phil Schloop is a 40-year resident of Rosedale Park. Retired business manager of the International Union of Operating Engineers Local 547. Long time health care advocate. Married to Melinda LePere, retired Open School teacher. Proud father and grandfather. Block club Captain, and GRDC board member. I enjoy rolling up my sleeves, and helping to continue building our community. It's a great place to live.



**DEBORAH GORE** | Board Member Candidate (2019-2021)

I have resided in Rosedale Park for 26 years. For the past 13 years I have served on various committees of the RPIA Board with two of those as President of RPIA. In addition, I currently serve as co-captain of my block and play piano for community events whenever requested. I am committed to supporting any effort that makes Rosedale Park a safe and great place to live.



**ULYSSES FREEMAN** | Board Member Candidate (2019-2021)

Born and raised in Detroit. Educated at Detroit Public Schools. Studied chemistry at Wayne State. Worked as chemist for DWSD. Retired as a water plant manager. Lived in Rosedale Park for about 33 years. Retirement has allowed me time to channel some my efforts into keeping the Rosedale Park community as beautiful of a place to live as it was when I first moved here.

## Annual Holiday Pancake Breakfast Saturday, Dec. 1 - 9am-11am

Let's kick off the holiday season with a fun family event - the annual Pancake Breakfast. This perennial favorite is sponsored by the Rosedale and North Rosedale neighborhood associations, and is open to everyone in the Grandmont Rosedale area. Adults \$4, Kids \$3.



Pancakes and syrup, turkey sausages, scrambled eggs, juice, milk and.....of course, a visit by Santa around 10:15 am to greet everyone and hand out small gifts to children. Come to enjoy, eat and sing holiday songs with your neighbors. This event is held at the North Rosedale Park Community House: 18445 Scarsdale.

### Events Calendar

#### NOVEMBER

Tuesday, Nov. 13

**RPIA Membership Meeting** - 7:00pm  
North Rosedale Community House  
18445 Scarsdale

Monday, Nov. 26

**RPIA Board Meeting** - 7:00pm  
GRDC Office  
19800 Grand River

#### DECEMBER

Saturday, Dec. 1

**Holiday Pancake Breakfast** - 9am-11am  
North Rosedale Community House  
18445 Scarsdale

Monday, Dec. 17

**RPIA Board Meeting** - 7:00pm  
GRDC Office  
19800 Grand River

Tuesday, Dec. 18

**Rosedale Park Radio Patrol** - 6:30pm  
TBD



# Not Too Late to Pay Your 2018 Rosedale Park Dues!

By RPIA Treasurer Frank Raben

Your RPIA dues support many activities for the residents of all 1600 Rosedale households. For the past few years, only about 600 of those 1600 households have paid their dues so that all can enjoy the privilege of calling Rosedale Park home.

The biggest portion of our dues (about 40%) pays for hiring a private contractor to clear our streets of snow during the winter months. But there's much more than snow removal: there is the annual Parade and Picnic, quarterly membership meetings, the weekly e-blast, bi-monthly print newsletters, new neighbor kits, the RPIA website, Holiday Pancake Breakfast, Easter Egg Hunt, 60 Block Garage Sale, organizing cleanup efforts at Rosedale Acacia Park and the Southfield service drive, maintaining the facades of our entrances from Grand River. I am sure I have probably missed something, but I think you get the idea of what you get for that annual dues of \$45 (NOTE: residents on Evergreen and Outer Dr pay only \$25 because their streets are plowed by Wayne County).

Rosedale is a great place to live and raise a family, so I hope I have laid a guilt trip on those who haven't yet paid your dues. Look at your dues as an investment into keeping Rosedale Park one of Detroit's premiere neighborhoods.

## Rosedale Park's Annual Gala

Friday, March 29, 2019

Our traditional RPIA gala (to swear in our new officers and recognize outstanding community service from various residents) will be postponed from late January to Friday, March 29, 2019.

The North Rosedale Community House kitchen will be undergoing renovations beginning Jan. 1, for 6-8 weeks. But don't worry – the Gala will be worth waiting for!

## RPIA General Membership Meeting

Tuesday, Nov. 13 - 7pm

Mark your calendar and plan to attend the November 13th General Membership meeting at 7 pm at the North Rosedale Community House, 18445 Scarsdale. Agenda includes the opportunity to vote for candidates for 2019 association officers and board members – light refreshments provided.

Bring a neighbor – see you there!

## RPIA Contacts List 2018

### Officers

#### President

Pam Weinstein  
Faust | 313.231.2244  
weinstein148@ameritech.net

#### First Vice President

Tony Mason  
Warwick  
313.910.4920  
T300vip@comcast.net

#### Second Vice President

Stacy Pugh  
Greenview  
313.574.8889  
pughsl2002@yahoo.com

#### Treasurer

Frank Raben  
Greenview  
313.770.7695  
rabenf47@gmail.com

### Board of Directors

Carolyn Akpe  
(2018) Artesian  
313.493.0824  
cjakpe@sbcglobal.net

Alex Derdelakos  
(2017-2019) Artesian  
734.620.4432  
alex@agddesigns.com

Phil Schloop  
(2016-2018) Ashton  
313.802.6447  
ps547@sbcglobal.net

Larry Castleberry  
(2017-2019) Faust  
313-549-5259  
lcastleb@sbcglobal.net

Jim Dwight  
(2018-2020) Faust  
313.231.2245  
jdwight99@ameritech.net

Kimberly Uhuru  
(2018-2020) Glastonbury  
313.460.8398  
kuhuru@gmail.com

Marion Cockrell  
(2017-2019) Grandville  
313.533.5984  
cockrell.m@att.net

Earl McCullough  
(2018-2020) Warwick  
313.912.6352  
earlmccullough19@yahoo.com

Debbie Gore  
(2016-2018) Glastonbury  
313.838.3243  
debbie\_gore@msn.com

### Key Contacts

#### Administrative Assistant

Priscilla McDonald  
313.283.4330  
pamcdonald@live.com

#### Block Captain Coordinator

Nancy Bitzarakis  
313.408.8420  
Nancy2061@aol.com

#### New Neighbor Kit Coordinator

Jill Laufer  
313.673.6697  
purejill@yahoo.com

#### RP NEWS Layout Designer

Andrew Laszczyk  
586.383.0732  
andrewlaszczyk@gmail.com

#### Administrator of Financial Records

Tandra Freeman  
Tandrafreeman1@gmail.com

#### eBlast Editor

David Legg  
313.549.2311  
rpiablast@gmail.com

#### RP NEWS Editor

Sara Carolin  
317.457.4937  
sara.carolin1442@gmail.com

#### RP Radio Patrol

Kathy Roland  
313.320.7185  
rrowtwo@aol.com

### Mail your 2018 RPIA dues Payment

Name(s) \_\_\_\_\_  
Address \_\_\_\_\_  
Email \_\_\_\_\_  
Phone \_\_\_\_\_

I want to volunteer. I am interested in:

I want to receive the weekly eBlast

Annual dues of \$45\* enclosed

Note: Outer Drive and Evergreen residents pay \$25

Make checks payable to "RPIA"

Mail payment to RPIA  
P.O. Box 23113  
Detroit, MI 48223

- OR -

Pay your 2018 RPIA dues ONLINE

www.rosedalepark.org



## Winter is Coming...

Our vibrant community is fortunate to be filled with retirees, working families, and young professionals. As all of us who have made it through Michigan's long winters know, getting to work, school, the grocery store, and even our place of worship can be a challenge when the weather turns and streets are not cleared - whether we drive, bike, rely on public transit or walk.

One of the great benefits of our Rosedale Park neighborhood is the snow removal service provided by RPIA. We recently renewed our contract for the 2018-2019 winter season, which guarantees snow removal after a complete snow of 3 or more inches fall by 6AM on weekdays or 8AM on weekends.

The success of this service requires the help of each of our neighbors. Vehicles, garbage and recycling courvilles should be removed from the streets so the plows can clear a complete path. Also, by making your annual contribution to RPIA by paying your dues, you help make this service - and all of the services and programs provided by RPIA possible.

Paying RPIA dues is easier than ever. Visit [rosedalepark.org](http://rosedalepark.org) to pay online or you can mail payment to RPIA at P.O. Box 23113, Detroit, MI 48223. Dues are just \$45 for most residents, \$25 for residents who live on Outer Dr. or Evergreen (Wayne County provides snow removal for these main roads).

## A Friendly Reminder: When it snows in Rosedale Park:

**MOVE CARS, COURVILLES & RECYCLING CARTS  
OFF THE STREETS!**

Rosedale residents are reminded to move all vehicles off the streets when snow is predicted.

RPIA pays a private contractor to plow the snow from our streets, so that we are all able to get to work and to school on time. If your vehicle is parked on the street, the snowplow driver has no choice but to plow you in.

Sometimes the snow may fly on a Sunday night/Monday morning. When that happens, be sure to place your Courville and Recycling Carts **UP ON YOUR BERM, NOT ON THE STREET!!** If you see your neighbor has forgotten, please remind them or lend a hand.

Working together, we can have a smooth winter season!

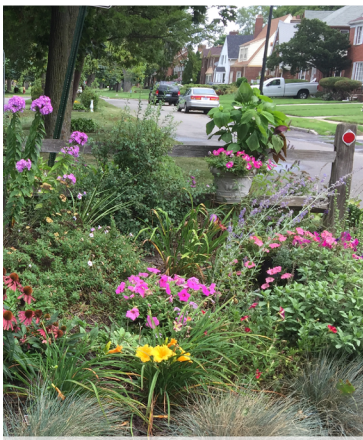

*Beautiful blooms on Most Improved Winners' Circle block Ashton from Chalfonte to Eaton.*



*Neighbors gather on Warwick Street to cheer on cyclists as Tour De Troit rolls through Rosedale Park.*

